

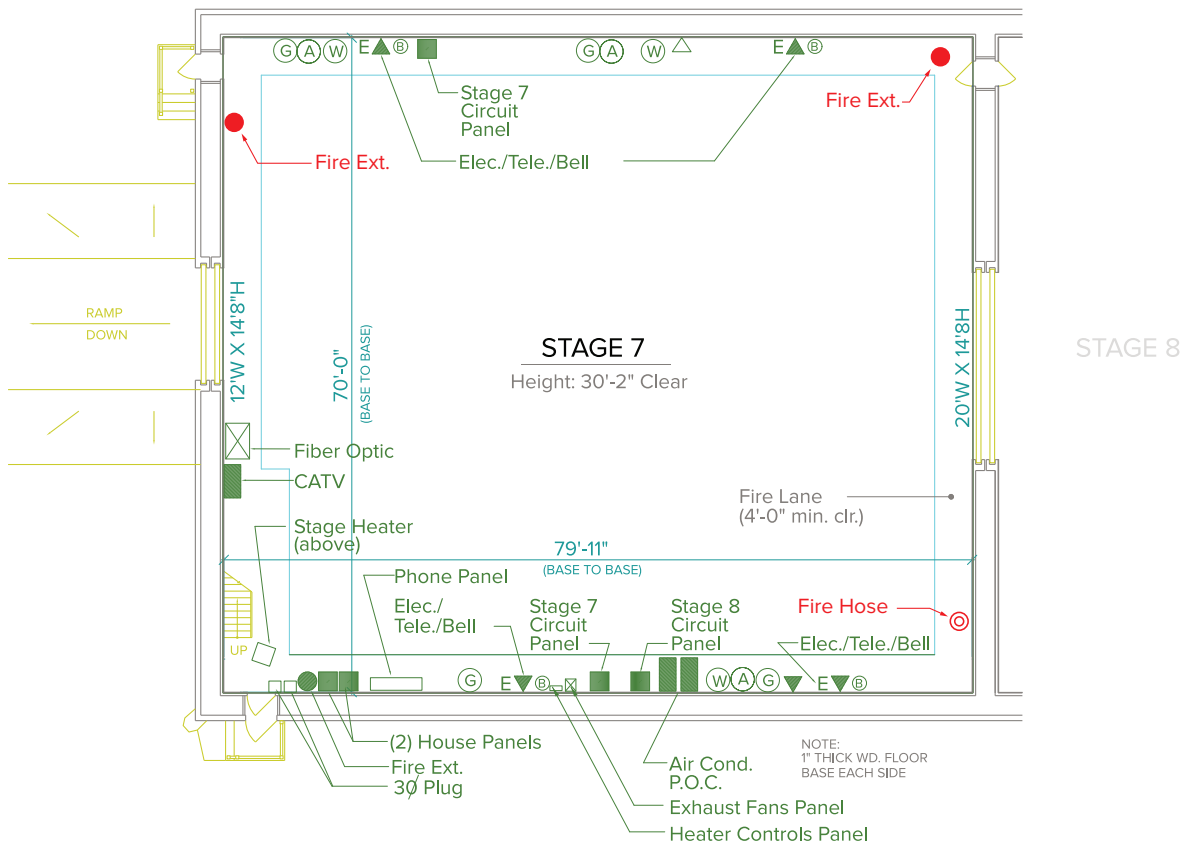

Stage 7
FLOORPLAN



SPECIFICATIONS

WIDTH	80'
LENGTH	70'
HEIGHT TO GRID	30'
TOTAL SQUARE FOOTAGE	5,600
ELEPHANT DOORS	North 12'x14' – South Interior 15'x14'
FLOOR TYPE	Wood Raised Foundation
WEIGHT LIMIT	15,000 lbs

ELECTRIC SERVICES

UP TO 3 CANS OF SHOOT POWER – EACH CAN IS 2,400 AMP / 3 PHASE / 208 VOLTS	Stages 7/8/9 – Share (3) 800 Amp 3- Phase Shoot Cans which Reside in Stage 8
50A OUTLETS 208V SINGLE PHASE	2
HOUSE POWER / 20A RECEPTACLES (120V SINGLE PHASE)	20

SUPPORT SPACE

DRESSING ROOMS / WARDROBE, HAIR & MAKEUP ROOMS AVAILABLE IN ADJACENT BUILDINGS

HVAC

20 TON PORTABLE COOLING UNIT	Available Upon Request
REDLIGHT & BELL SYSTEM	Available
VENTILATION	Exhaust Fans
HEATING	Stage Heater
SILENT AIR	Not Available

EXTRAS

TRAILER HOOKUPS	Available
GAS CONNECTIONS	Available
COMPRESSED AIR	Available
WIRELESS INTERNET	Available
HAZMAT SERVICES	Available Upon Request
PORTABLE DRESSING ROOMS	Available Upon Request



Stage 8
FLOORPLAN

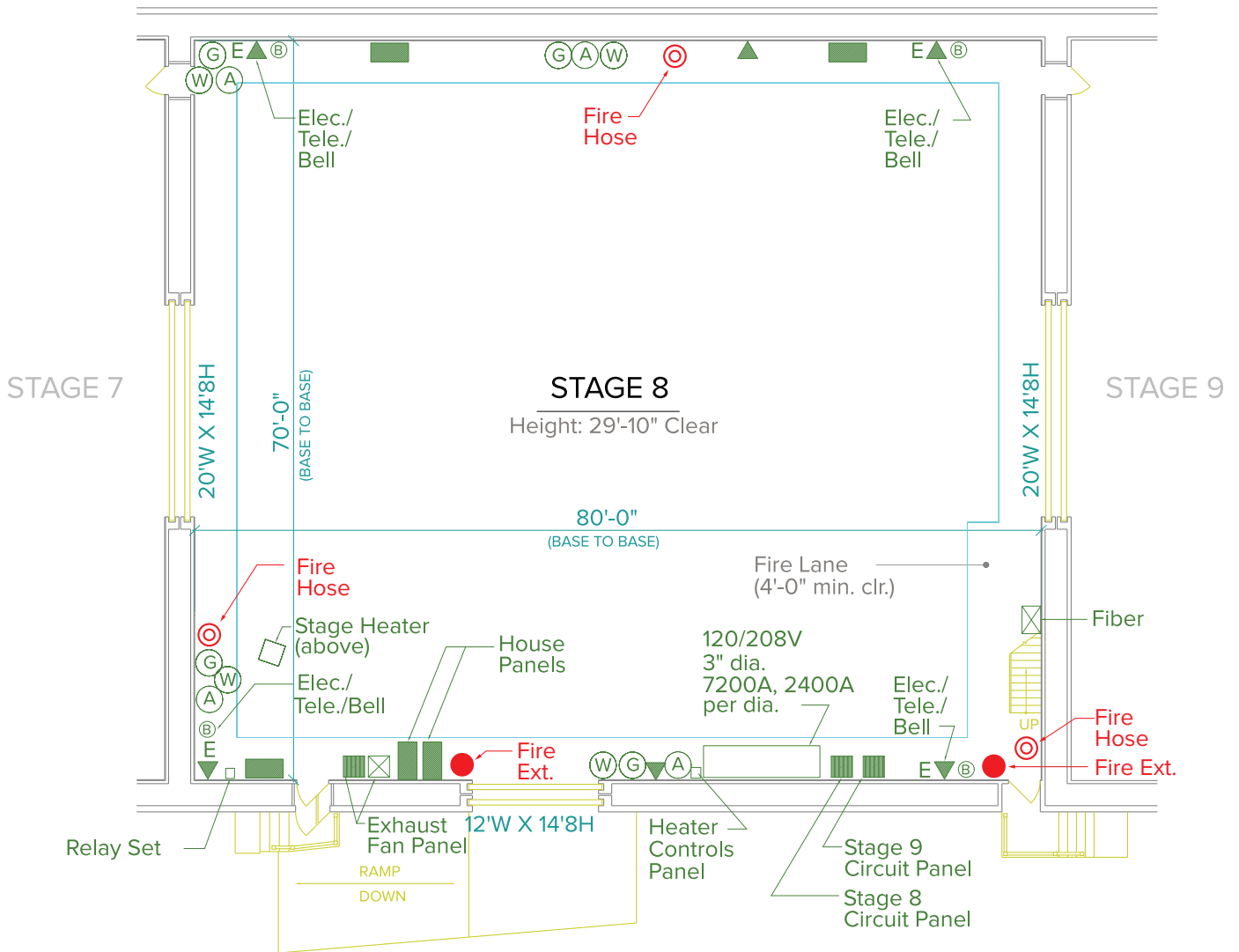

NOTE:
3/4" THICK WD. FLOOR
BASE EACH SIDE

SPECIFICATIONS

WIDTH	80'
LENGTH	70'
HEIGHT TO GRID	29'
TOTAL SQUARE FOOTAGE	5,600
ELEPHANT DOORS	West 12'x14' – North Interior 15'x14' – South Interior 19'x14'
FLOOR TYPE	Wood Raised Foundation
WEIGHT LIMIT	15,000 lbs

ELECTRIC SERVICES

UP TO 3 CANS OF SHOOT POWER – EACH CAN IS 2,400 AMP / 3 PHASE / 208 VOLTS	Stages 7/8/9 – Share (3) 800 Amp 3- Phase Shoot Cans which Reside in Stage 8
50A OUTLETS 208V SINGLE PHASE	1
HOUSE POWER / 20A RECEPTACLES (120V SINGLE PHASE)	20

SUPPORT SPACE

DRESSING ROOMS / WARDROBE, HAIR & MAKEUP ROOMS AVAILABLE IN ADJACENT BUILDINGS

HVAC

20 TON PORTABLE COOLING UNIT	Available Upon Request
REDLIGHT & BELL SYSTEM	Available
VENTILATION	Exhaust Fans
HEATING	Stage Heater
SILENT AIR	Not Available

EXTRAS

TRAILER HOOKUPS	Available
GAS CONNECTIONS	Available
COMPRESSED AIR	Available
WIRELESS INTERNET	Available
HAZMAT SERVICES	Available Upon Request
PORTABLE DRESSING ROOMS	Available Upon Request



Stage 9
FLOORPLAN

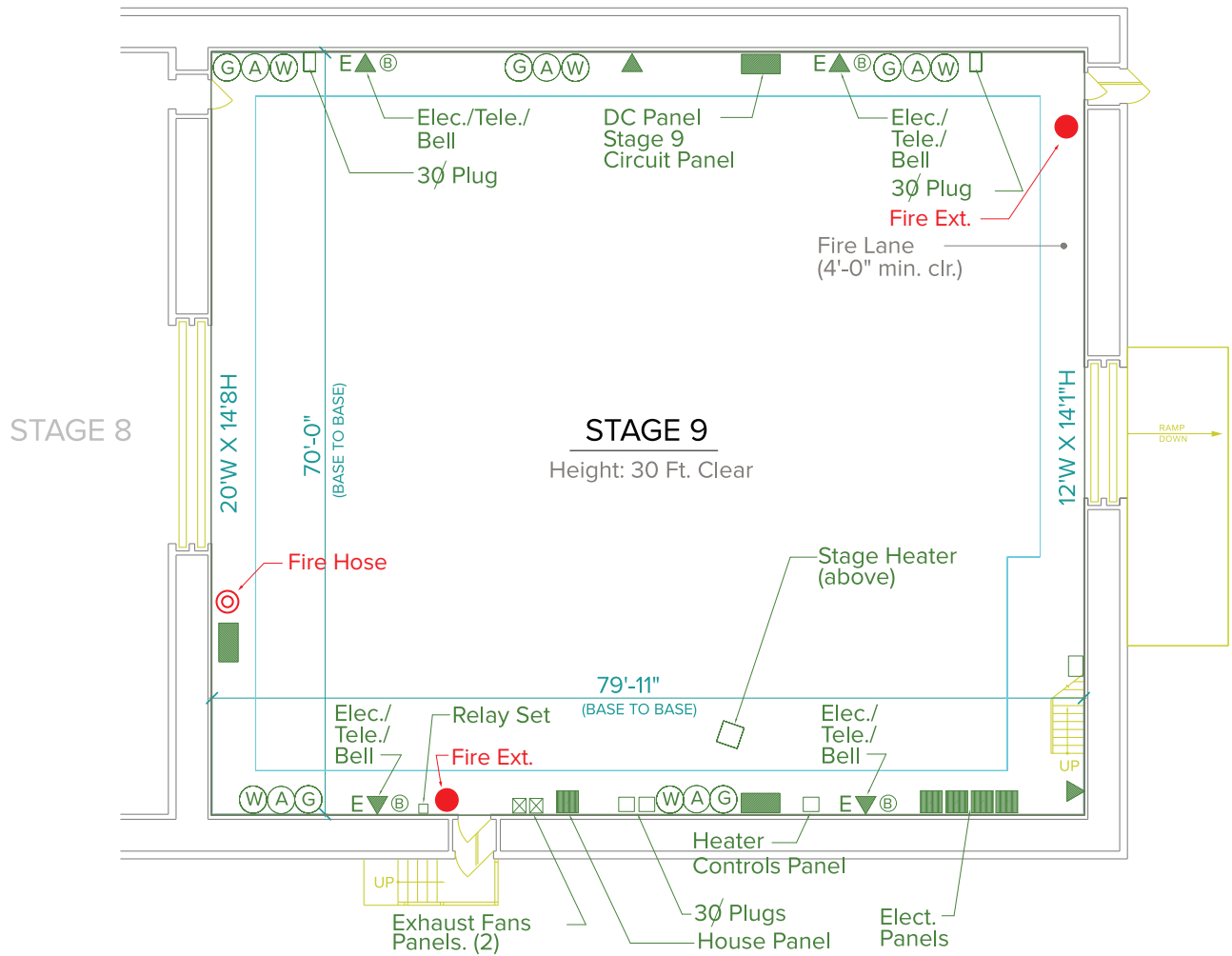

SPECIFICATIONS

WIDTH	80'
LENGTH	70'
HEIGHT TO GRID	29'
TOTAL SQUARE FOOTAGE	5,600
ELEPHANT DOORS	South 12x14 – North Interior 19x14
FLOOR TYPE	Wood Raised Foundation
WEIGHT LIMIT	15,000 lbs

ELECTRIC SERVICES

UP TO 3 CANS OF SHOOT POWER – EACH CAN IS 2,400 AMP / 3 PHASE / 208 VOLTS	Stages 7/8/9 – Share (3) 800 Amp 3- Phase Shoot Cans which Reside in Stage 8
50A OUTLETS 208V SINGLE PHASE	2
90A 3PH MELTRIC POWER OUTLETS (208V)	1
HOUSE POWER / 20A RECEPTACLES (120V SINGLE PHASE)	20

SUPPORT SPACE

DRESSING ROOMS / WARDROBE, HAIR & MAKEUP ROOMS AVAILABLE IN ADJACENT BUILDINGS

HVAC

20 TON PORTABLE COOLING UNIT	Available Upon Request
REDLIGHT & BELL SYSTEM	Available
VENTILATION	Exhaust Fans
HEATING	Stage Heater
SILENT AIR	40 Tons with a Chiller on the Exterior of the Stage Ducted Inside

EXTRAS

TRAILER HOOKUPS	Available
GAS CONNECTIONS	Available
COMPRESSED AIR	Available
WIRELESS INTERNET	Available
HAZMAT SERVICES	Available Upon Request
PORTABLE DRESSING ROOMS	Available Upon Request

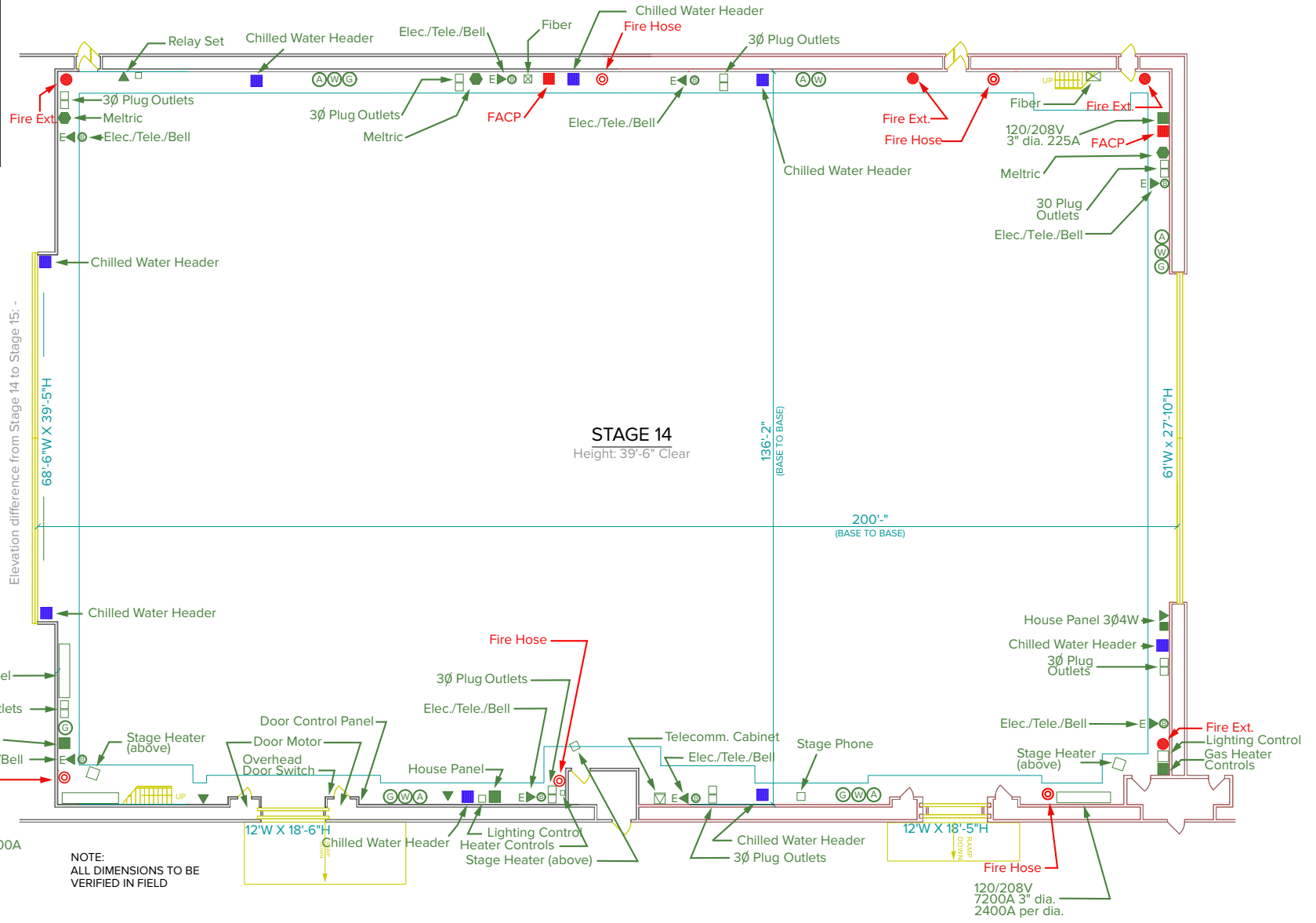
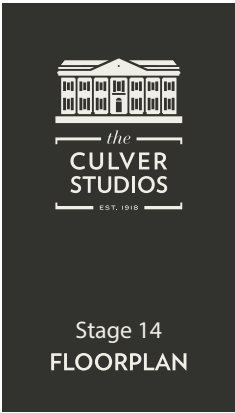

SPECIFICATIONS

WIDTH	136'
LENGTH	200'
HEIGHT TO GRID	39'
TOTAL SQUARE FOOTAGE	27,200
ELEPHANT DOORS	North Interior 61' by 28' To Stg. 11 South Interior 68' 6" x 39' 5" To Stg. 15 South East 12' x 18' 6" To Spine North East 12' x 16' To Spine
FLOOR TYPE	Wood Raised Foundation
WEIGHT LIMIT	15,000 lbs
OPENS TO STAGES	11 & 15
ELEVATION CHANGE OF 34 1/2" FROM STAGE 14 TO 15	

ELECTRIC SERVICES

UP TO 6 CANS OF SHOOT POWER – EACH CAN IS 2,400 AMP / 3 PHASE / 208 VOLTS	14,400 Amps Available
50A OUTLETS 208V SINGLE PHASE	1
90A 3PH MELTRIC POWER OUTLETS (208V)	3
HOUSE POWER / 20A RECEPTACLES (120V SINGLE PHASE)	50

SUPPORT SPACE

AVAILABLE IN ADJACENT

HVAC

20 TON PORTABLE COOLING UNIT	Available Upon Request
CHILLED WATER CAPACITY	Up to 40 Tons Per Header
REDLIGHT & BELL SYSTEM	Available
VENTILATION	Exhaust Fans Upon Request
HEATING	Stage Heater Upon Request

EXTRAS

TRAILER HOOKUPS	Available Upon Request
GAS CONNECTIONS	Available
COMPRESSED AIR	Available
WIRELESS INTERNET	Available Upon Request
HAZMAT SERVICES	Available Upon Request

